

605-7 INDUSTRIAL BUILDING



Buildings 605-7 and 605-10 are connected buildings for a total of 26,450 square feet.

605-7 FEATURES

8,400 S.F. AVAILABLE

- 8,400 S.F. of industrial/office space available
- Approximately 14' floor to roof height
- 1-story facility built in 1976 constructed of prefabricated steel structures with slab on-grade floors
- Approximately 80 parking spaces

WHITAKER PARK 605-7 INDUSTRIAL

FLOOR PLAN

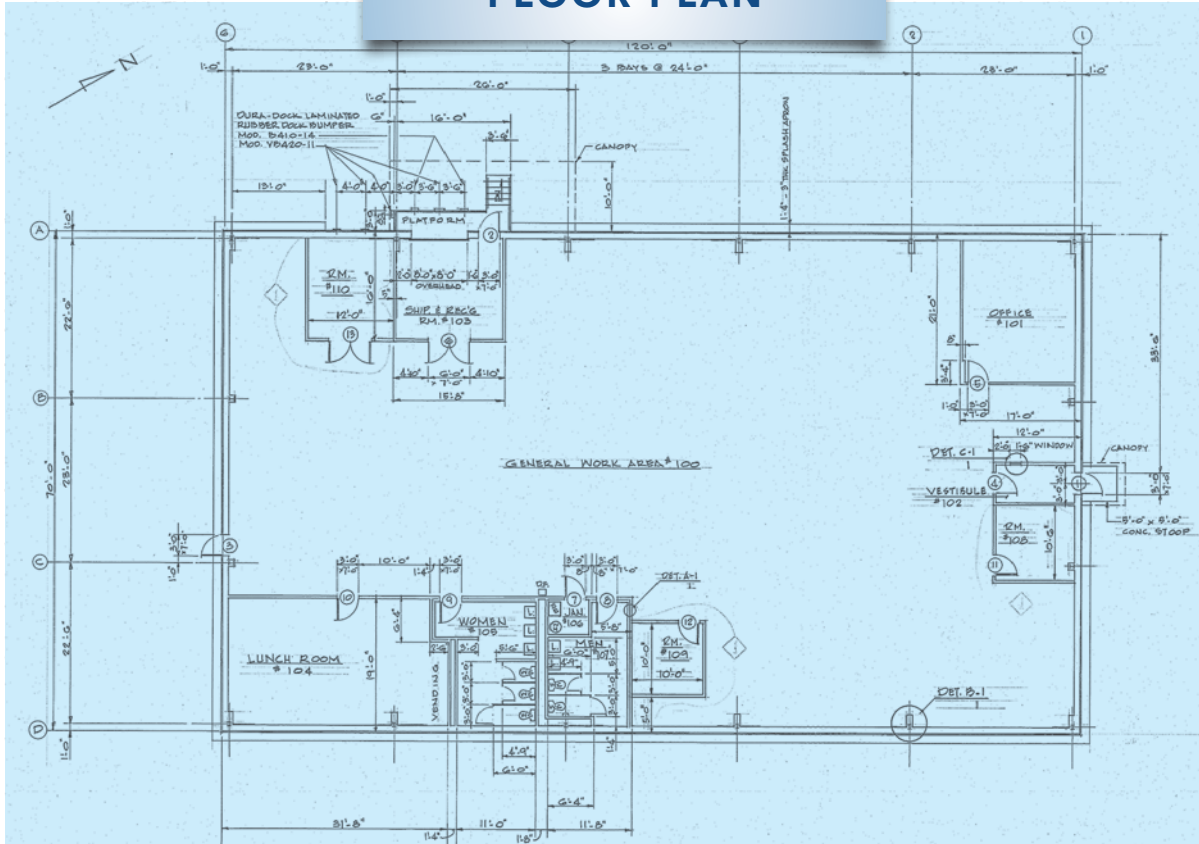

LOCATION

